

Nextage

# **BYOM - Embrace the Next Level BYOD**

**4K** Wireless Presentation system-SHARPSHARE SS40



# What is BYOM (Bring your own meeting)?

**Define YOUR OWN WAY to LAUNCH a NEW MEETING.**

In today's workplaces, many people tend to bring their own device to the office. As a natural extension of BYOD, BYOM allows you to connect wirelessly to the meeting room screen with your own device, and start the video conference using your preferred UC platform (Microsoft Teams, Zoom, Webex).



# Application Example

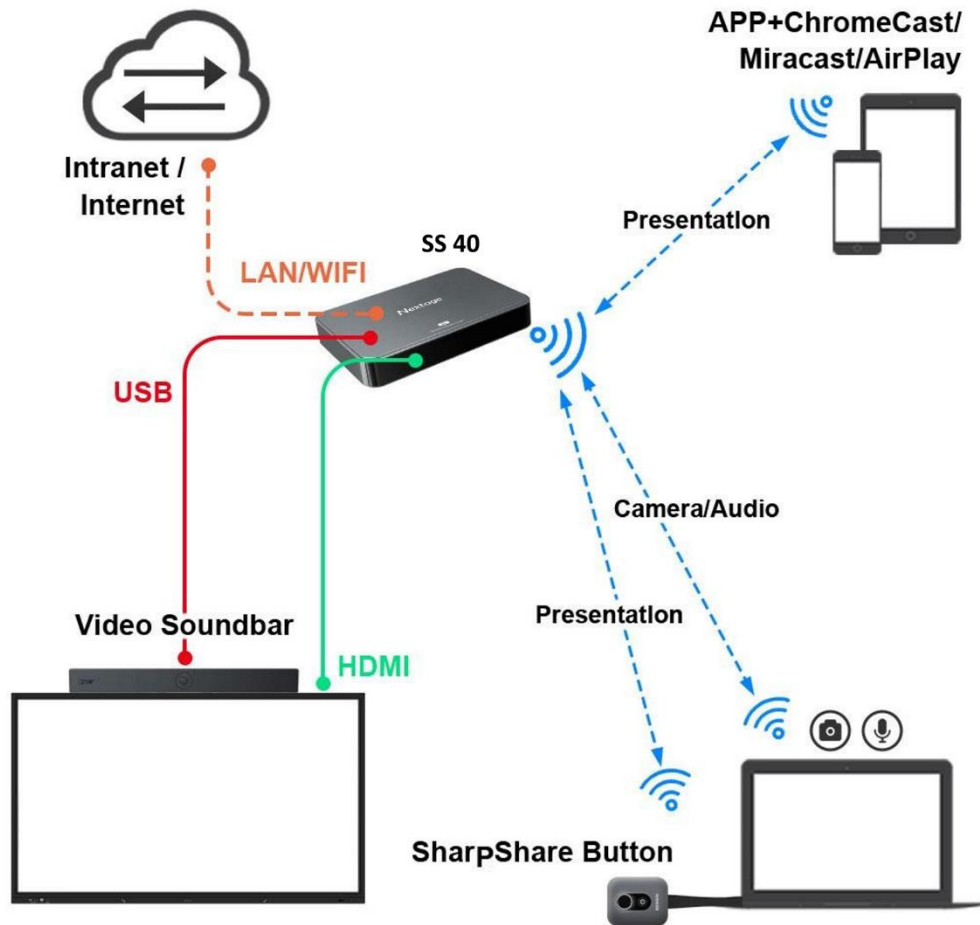

## Bring Your Own Meeting

Wireless conferencing with brilliant Full HD camera resolution.

## Easy Screen Share

Laptops can be presented through software client or plugging a Button, while smartphones and tablets connect via mobile App or screen mirroring (AirPlay, Google Cast or Miracast).

## Any Presentation Display

No matter there is a projector, TV or touch screen in your boardroom, as long as the display is with HDMI input, just plug and play to go wireless.

## Multi-System Compatibility



# Say Goodbye to UC Incompatibility

SharpShare SS40 is compatible with almost all USB cameras, USB video soundbars, USB speakerphones and professional AEC (Acoustic Echo Cancellation) solutions with USB interface.



# Automatic Meeting Flow Boosts Productivity

Avoid spending time to set up hybrid meetings with your unfamiliar AV equipment, simply walk into the meeting room and connect wirelessly to the existing facilities, without pausing your ongoing video call. No cables, no mess.



# Remote Collaboration Never Been Easier

Designed with BYOM in mind, SharpShare SS40 brings intuitive collaboration experience to your hybrid meeting by allowing remote participants to share their personal screen or view content shared on the room display with no requirement of the same LAN.

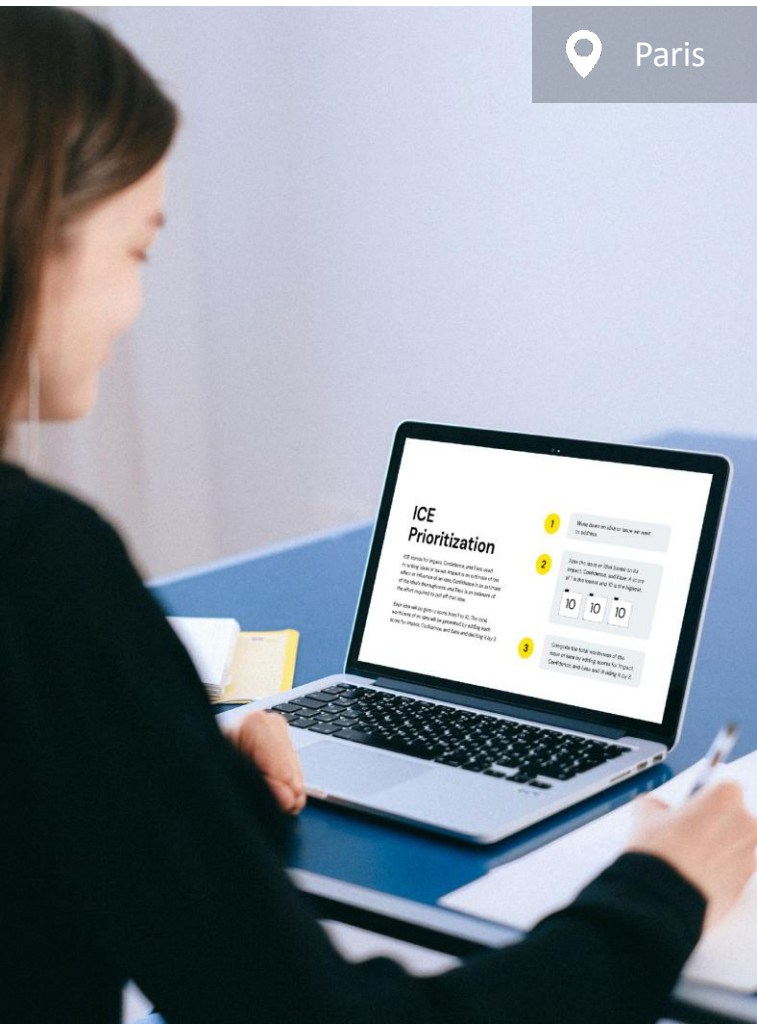

# 4K UHD Screen Mirror

Upgraded 4K UHD screen share, making it possible to enjoy a clearer vision and more details on the office display.

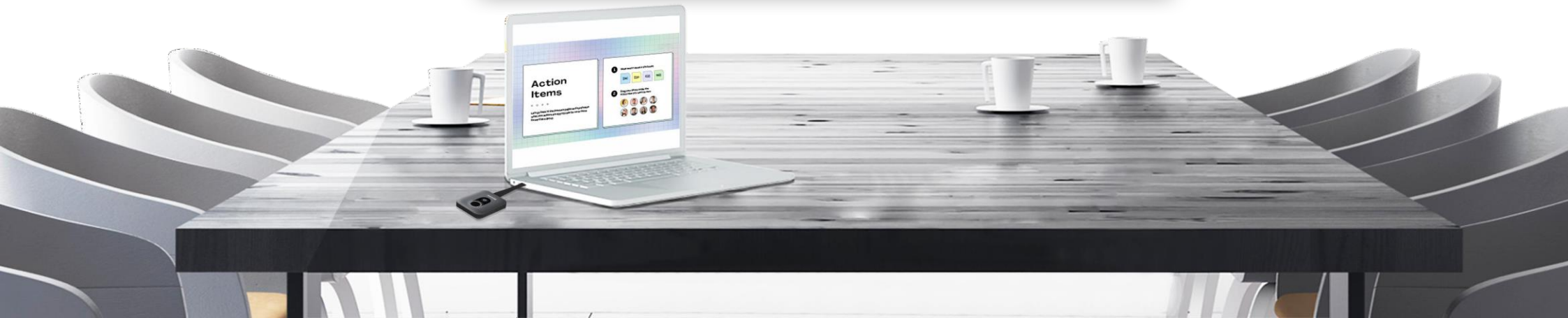
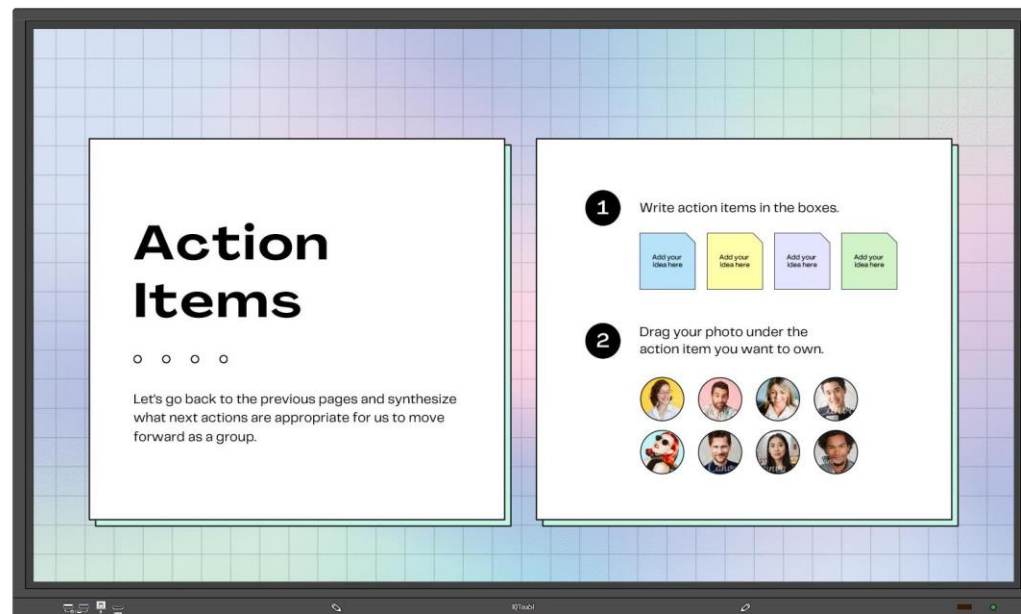

# Wireless, Wide-range, Stable Transmission

With dual-band 2.4G & 5G wifi, SharpShare SS40 supports 35m transmission distance with low latency, which can be used for any size of conference rooms. The long-lasting stability of screen sharing also allows you to smoothly show the ideas without being disrupted.

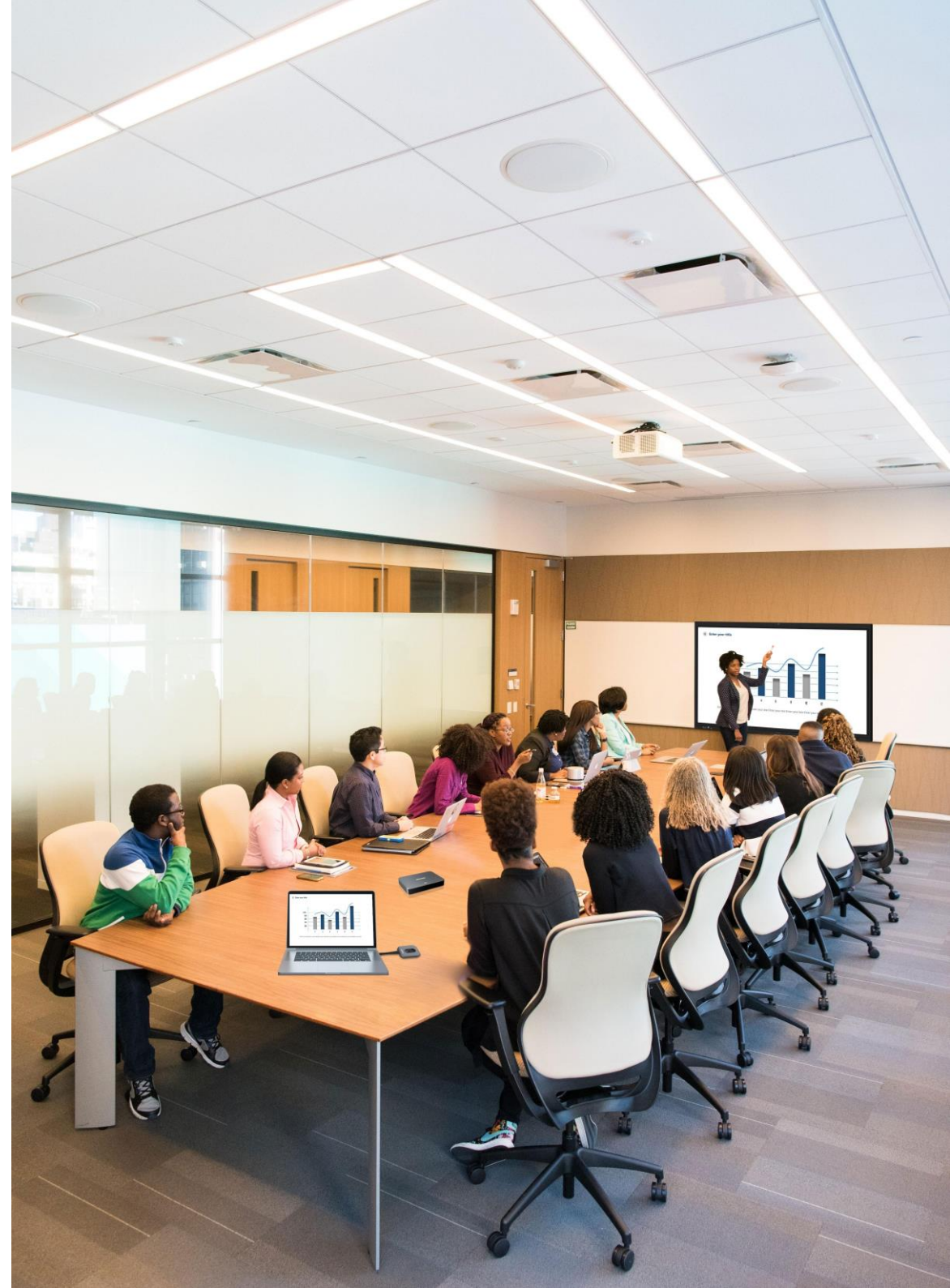

# Two-way Screen Share & Control

Wirelessly share the screen content on your personal device to the office display, and the rest of the team can see from both the office display and their own devices.





# Give Everyone A World Showing The Ideas

Multiple split screens make it possible to share various ideas on one display simultaneously. Give the group a world full of creativity, which stimulates brainstorming and team discussion.

## At the same time

- More than 32 users can be connected
- Max 8 buttons connected
- 4-split screen displayed

# Privacy Protected

## Reliable Encryption

SharpShare adopts the Advanced Encryption Standard (AES) of security to prevent data leakage, which safeguards your privacy.



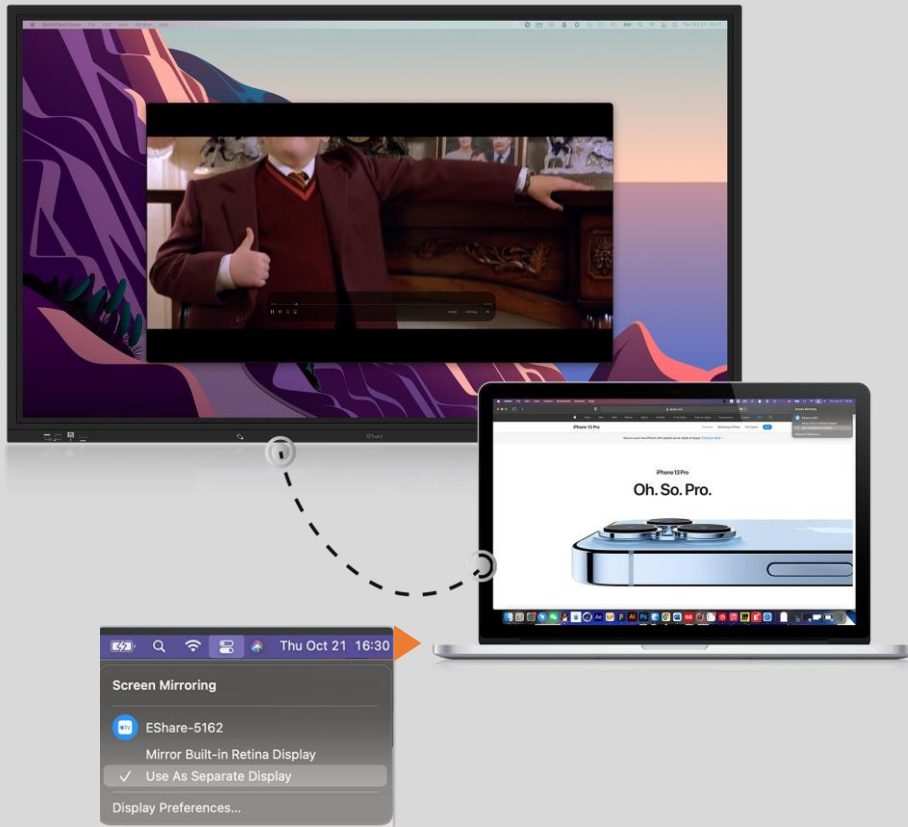

## Extended screen

User can set the office display as an extended screen and directly drag the presentation content to the big screen without exposing the rest of his PC desktop.



## Freeze screen

No need to disconnect the screen sharing when you want to deal with some personal stuff on your device, just freeze the content being shared on the big screen.

# Maximum Visibility by Group Display

With multiple displays in a room, connecting each one of them to an SharpShare box respectively and make them as one group, they will be able to receive the same content wirelessly at the same time.



(1) From one personal device to multiple displays

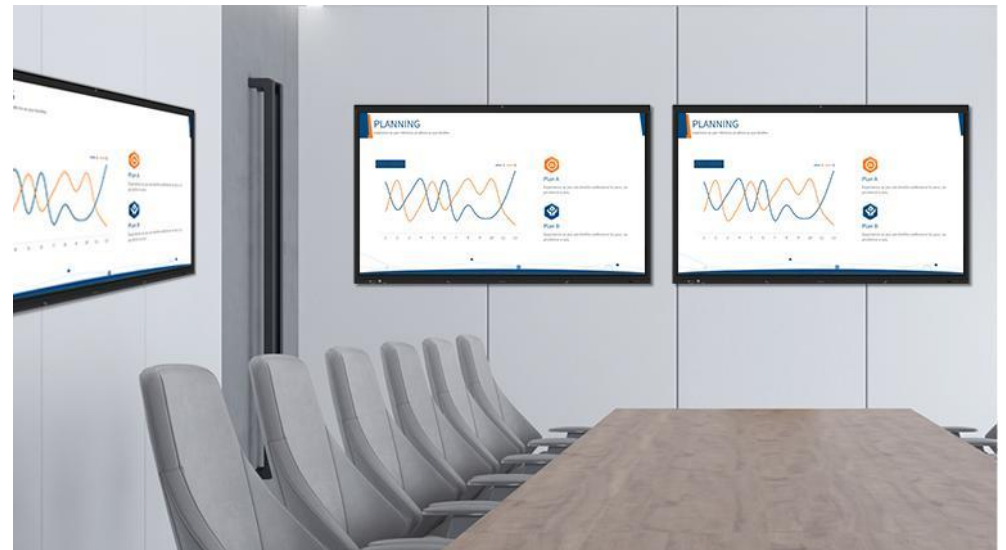

(2) From one display to the rest of the displays

# SharpShare Operating System

Based on the Android 9.0 deeply customized wireless presentation system, screen sharing operation becomes simpler. With the annotation, whiteboard, reverse control, and other interactive collaboration functions supported, you would not be interrupted while coming up with some new inspiration. Greatly improve the efficiency of decision-making in the meeting.

## Two Themes

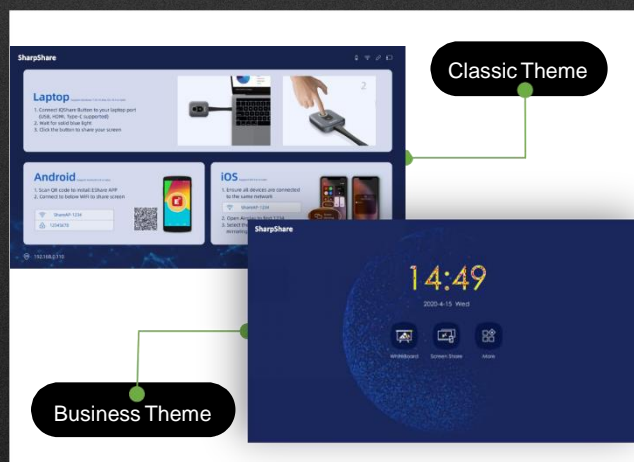

Classic Theme & Business Theme

## Annotate Anytime And Anywhere

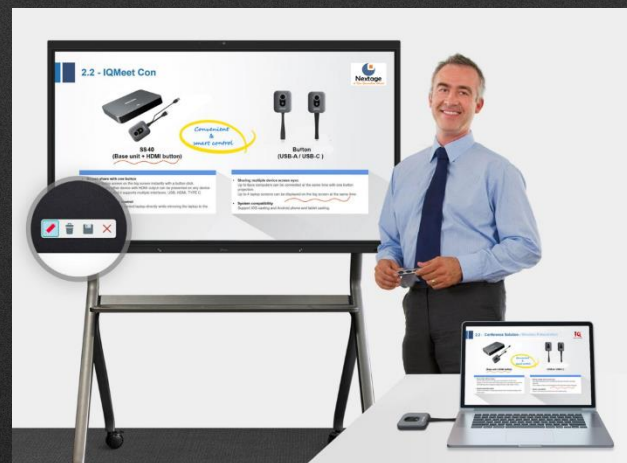

Freely annotate the content shared by the group on the large screen.

## Whiteboard Writing



All tools provided on the whiteboard bring you an interactive meeting.

# Requiring No Network and Installation

For guests who don't have access to the company network, they can share personal mobile devices wirelessly through SharpShare Button. There is no requirement for network and software installations. The user-friendly design with one-click to share brings you a hassle-free experience.



# Screen Sharing Way in Different Systems



<b>Model</b>	<b>SS40</b>
<b>Windows 10</b>	Software Client / SharpShare Button
<b>MacOS</b>	Software Client / AirPlay / SharpShare Button
<b>Chrome OS</b>	Software Client / Chromecast / SharpShare Button
<b>Linux (Ubuntu)</b>	Software Client / SharpShare Button
<b>Mobile devices</b>	Android App / IOS App / AirPlay

# 3 Types of SharpShare Buttons (Optional)



Model	H4	C4	U4
Interface	HDMI(19PIN) USB-A	USB-C (With DisplayPort Alternate Mode)	USB-A
Output resolution	4K@30FPS	4K@30FPS	4K@30FPS
Video standard	HDMI1.4	DP1.2, eDP1.4	N/A
USB standard	2.0	2.0	2.0
Audio	16bit 44KHz	16bit 44KHz	16bit 44KHz
USB HID function	YES	YES	YES
BYOM function	YES	YES	NO

# Nextage

# THANKS



Nextage Technologies



504, Kirti Shikhar Tower, District Center, Janakpur, New  
Delhi – 110058 India



+91 – 11 – 45120405



+91 – 8447455496



[www.nextageindia.in](http://www.nextageindia.in) / [www.nextageindia.com](http://www.nextageindia.com)



[sales@nextageindia.in](mailto:sales@nextageindia.in)